

B200002

SAN

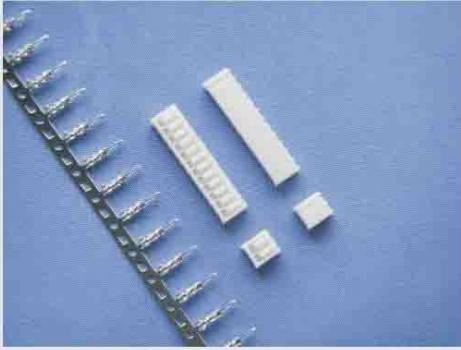

▶ 主要技术特性 (Main Specifications)

- ▶ 适用导线规格 (Applicable wire) : AWG30#~24#
- ▶ 适用基板厚度 (Applicable PC board thickness) : 0.8mm~1.6mm
- ▶ 温度范围 (Temperature range) : -25°C~+85°C
- ▶ 额定电压 (Voltage rating) : 250V AC, DC
- ▶ 额定电流 (Current rating) : 2A AC, DC
- ▶ 接触电阻 (Contact resistance) : $\leq 0.02 \Omega$
- ▶ 绝缘电阻 (Insulation resistance) : $\geq 1000M \Omega$
- ▶ 耐压 (Withstanding voltage) : 800V AC/minute

材料及电镀规格 Material and Finish

型号 Type	材料 Material	材料厚度 Material Thickness	电镀规格 Finish
孔座 HOUSING	PA66 UL94V-0	—	N/A
端子 TERMINAL	锡青铜 Phosphor bronze	0.2mm	镀锡 Tin-plated

产品尺寸图 Product size chart

 单位: mm 一般公差: ± 0.20

TERMINAL

B200002-4B

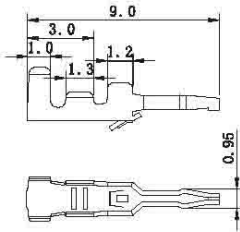

安装尺寸 (Mounting measurement)

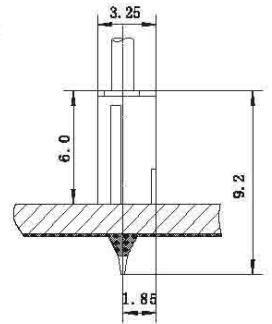
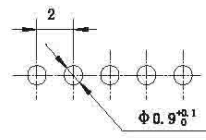

B200002-4E

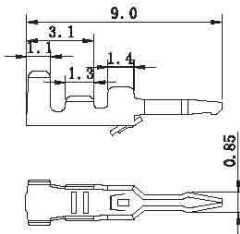

HOUSING

B200001-2

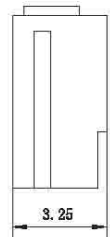
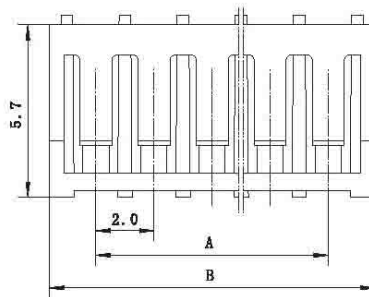

HOUSING

极数 Circuits	型号 Type	尺寸 (Dimensions) mm		备注型号 P. S. Type
		A	B	
2	B200002-2-02	2.0	5.2	SAN-02P
3	B200002-2-03	4.0	7.2	SAN-03P
4	B200002-2-04	6.0	9.2	SAN-04P
5	B200002-2-05	8.0	11.2	SAN-05P
6	B200002-2-06	10.0	13.2	SAN-06P
7	B200002-2-07	12.0	15.2	SAN-07P
8	B200002-2-08	14.0	17.2	SAN-08P
9	B200002-2-09	16.0	19.2	SAN-09P
10	B200002-2-10	18.0	21.2	SAN-10P
11	B200002-2-11	20.0	23.2	SAN-11P
16	B200002-2-16	30.0	33.2	SAN-16P