

B250009

SM



- ▶ 主要技术特性 (Main Specifications)
- ▶ 适用导线规格 (Applicable wire) : AWG28#~22#
- ▶ 适用基板厚度 (Applicable PC board thickness) : —
- ▶ 温度范围 (Temperature range) : -25°C ~ +85°C
- ▶ 额定电压 (Voltage rating) : 250V AC, DC
- ▶ 额定电流 (Current rating) : 3A AC, DC
- ▶ 接触电阻 (Contact resistance) : $\leq 0.02\Omega$
- ▶ 绝缘电阻 (Insulation resistance) : $\geq 1000M\Omega$
- ▶ 耐压 (Withstanding voltage) : 1000V AC/minute

材料及电镀规格 Material and Finish

型号 Type	材料 Material	材料厚度 Material Thickness	电镀规格 Finish
胶座 HOUSING	PA66 UL94V-0	—	N/A
端子 TERMINAL (针PIN)	磷青铜 Phosphor bronze	0.25mm	镀锡 Tin-plated
端子 TERMINAL	磷青铜 Phosphor bronze	0.2mm	镀锡 Tin-plated

产品尺寸图 Product size chart

 单位: mm 一般公差: ± 0.20

TERMINAL

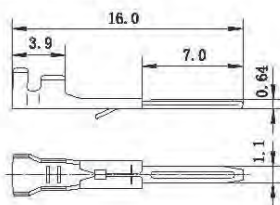
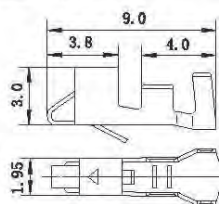
B250009-3 **SM-A**

B250009-4 **SM-Y**

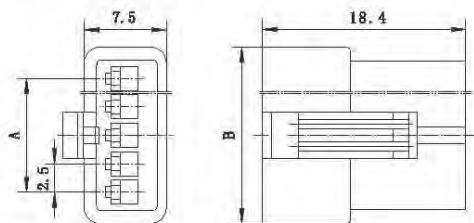
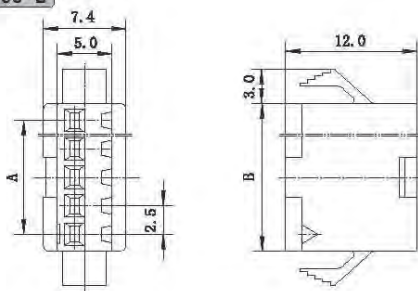
HOUSING

B250009-1

B250009-2

HOUSING

极数 Circuits	型号 Type	尺寸 (Dimensions) mm		备注型号 P. S. Type
		A	B	
2	B250009-1-02	2.5	8.0	SM-02R
3	B250009-1-03	5.0	10.5	SM-03R
4	B250009-1-04	7.5	13.0	SM-04R
5	B250009-1-05	10.0	15.5	SM-05R
6	B250009-1-06	12.5	18.0	SM-06R
7	B250009-1-07	15.0	20.5	SM-07R
8	B250009-1-08	17.5	23.0	SM-08R
9	B250009-1-09	20.0	25.5	SM-09R
10	B250009-1-10	22.5	28.0	SM-10R
11	B250009-1-11	25.0	30.5	SM-11R
12	B250009-1-12	27.5	33.0	SM-12R

B250009

SM

HOUSING

极数 Circuits	型号 Type	尺寸(Dimensions)mm		备注型号 P. S. Type
		A	B	
2	B250009-2-02	2.5	5.5	SM-02P
3	B250009-2-03	5.0	8.0	SM-03P
4	B250009-2-04	7.5	10.5	SM-04P
5	B250009-2-05	10.0	13.0	SM-05P
6	B250009-2-06	12.5	15.5	SM-06P
7	B250009-2-07	15.0	18.0	SM-07P
8	B250009-2-08	17.5	20.5	SM-08P
9	B250009-2-09	20.0	23.0	SM-09P
10	B250009-2-10	22.5	25.5	SM-10P
11	B250009-2-11	25.0	28.0	SM-11P
12	B250009-2-12	27.5	30.5	SM-12P

HOUSING

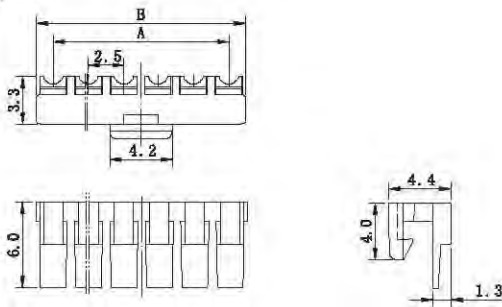
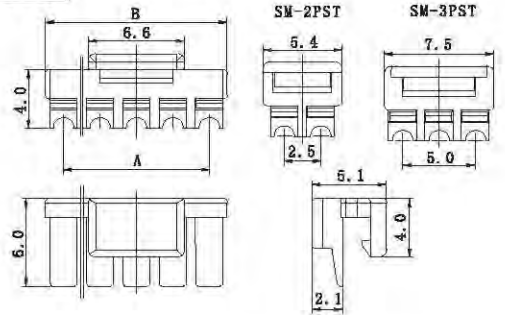
B250009-5

B250009-5A

HOUSING

极数 Circuits	型号 Type	尺寸(Dimensions)mm		备注型号 P. S. Type
		A	B	
2	B250009-5-02	2.5	4.9	SM-02RST
3	B250009-5-03	5.0	7.4	SM-03RST
4	B250009-5-04	7.5	9.9	SM-04RST
5	B250009-5-05	10.0	12.4	SM-05RST
6	B250009-5-06	12.5	14.9	SM-06RST
7	B250009-5-07	15.0	17.4	SM-07RST
8	B250009-5-08	17.5	19.9	SM-08RST

极数 Circuits	型号 Type	尺寸(Dimensions)mm		备注型号 P. S. Type
		A	B	
2	B250009-5A-02	2.5	5.4	SM-02PST
3	B250009-5A-03	5.0	7.5	SM-03PST
4	B250009-5A-04	7.5	10.0	SM-04PST
5	B250009-5A-05	10.0	12.5	SM-05PST
6	B250009-5A-06	12.5	15.0	SM-06PST
7	B250009-5A-07	15.0	17.5	SM-07PST
8	B250009-5A-08	17.5	20.0	SM-08PST

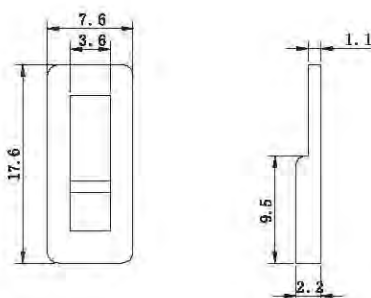
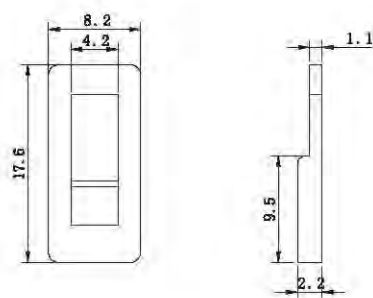
HOUSING

B250009-5B-02
SMB-02

B250009-5B-03
SMB-03

B250009

SM

HOUSING

极数 Circuits	型号 Type	尺寸(Dimensions)mm		备注型号 P. S. Type
		A	B	
2	B250009-2-02	2.5	5.5	SM-02P
3	B250009-2-03	5.0	8.0	SM-03P
4	B250009-2-04	7.5	10.5	SM-04P
5	B250009-2-05	10.0	13.0	SM-05P
6	B250009-2-06	12.5	15.5	SM-06P
7	B250009-2-07	15.0	18.0	SM-07P
8	B250009-2-08	17.5	20.5	SM-08P
9	B250009-2-09	20.0	23.0	SM-09P
10	B250009-2-10	22.5	25.5	SM-10P
11	B250009-2-11	25.0	28.0	SM-11P
12	B250009-2-12	27.5	30.5	SM-12P

HOUSING

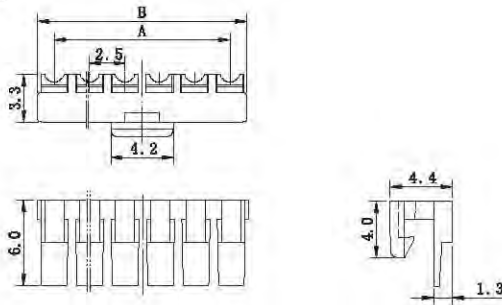
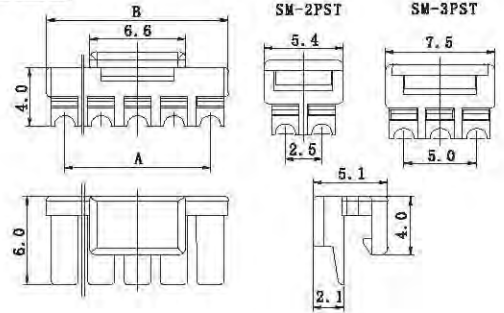
B250009-5

B250009-5A

HOUSING

极数 Circuits	型号 Type	尺寸(Dimensions)mm		备注型号 P. S. Type
		A	B	
2	B250009-5-02	2.5	4.9	SM-02RST
3	B250009-5-03	5.0	7.4	SM-03RST
4	B250009-5-04	7.5	9.9	SM-04RST
5	B250009-5-05	10.0	12.4	SM-05RST
6	B250009-5-06	12.5	14.9	SM-06RST
7	B250009-5-07	15.0	17.4	SM-07RST
8	B250009-5-08	17.5	19.9	SM-08RST

极数 Circuits	型号 Type	尺寸(Dimensions)mm		备注型号 P. S. Type
		A	B	
2	B250009-5A-02	2.5	5.4	SM-02PST
3	B250009-5A-03	5.0	7.5	SM-03PST
4	B250009-5A-04	7.5	10.0	SM-04PST
5	B250009-5A-05	10.0	12.5	SM-05PST
6	B250009-5A-06	12.5	15.0	SM-06PST
7	B250009-5A-07	15.0	17.5	SM-07PST
8	B250009-5A-08	17.5	20.0	SM-08PST

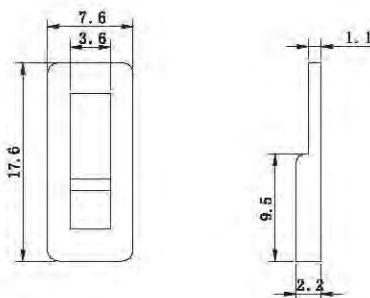
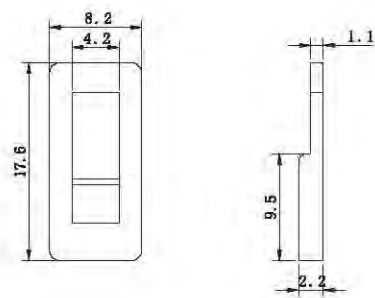
HOUSING

B250009-5B-02
SMB-02

B250009-5B-03
SMB-03

B250009

SM

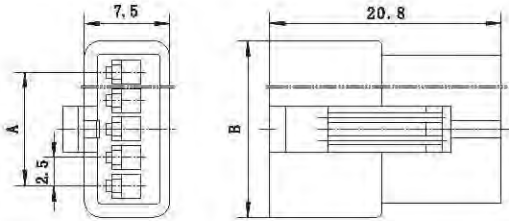
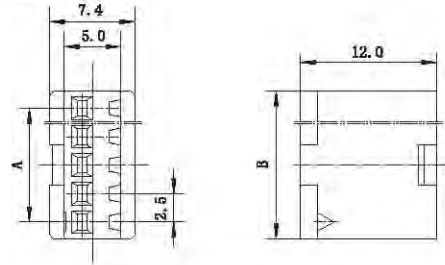
HOUSING

B250009-1L

B250009-2-*F

HOUSING

极数 Circuits	型号 Type	尺寸(Dimensions)mm		备注型号 P. S. Type
		A	B	
2	B250009-1L-02	2.5	8.0	SML-02R
3	B250009-1L-03	5.0	10.5	SML-03R
4	B250009-1L-04	7.5	13.0	SML-04R
5	B250009-1L-05	10.0	15.5	SML-05R
6	B250009-1L-06	12.5	18.0	SML-06R
7	B250009-1L-07	15.0	20.5	SML-07R
8	B250009-1L-08	17.5	23.0	SML-08R
9	B250009-1L-09	20.0	25.5	SML-09R
10	B250009-1L-10	22.5	28.0	SML-10R
11	B250009-1L-11	25.0	30.5	SML-11R
12	B250009-1L-12	27.5	33.0	SML-12R

极数 Circuits	型号 Type	尺寸(Dimensions)mm		备注型号 P. S. Type
		A	B	
2	B250009-2-02F	2.5	5.5	SM-02PF
3	B250009-2-03F	5.0	8.0	SM-03PF
4	B250009-2-04F	7.5	10.5	SM-04PF
5	B250009-2-05F	10.0	13.0	SM-05PF
6	B250009-2-06F	12.5	15.5	SM-06PF
7	B250009-2-07F	15.0	18.0	SM-07PF
8	B250009-2-08F	17.5	20.5	SM-08PF
9	B250009-2-09F	20.0	23.0	SM-09PF
10	B250009-2-10F	22.5	25.5	SM-10PF
11	B250009-2-11F	25.0	28.0	SM-11PF
12	B250009-2-12F	27.5	30.5	SM-12PF

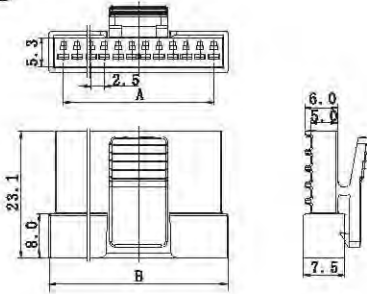
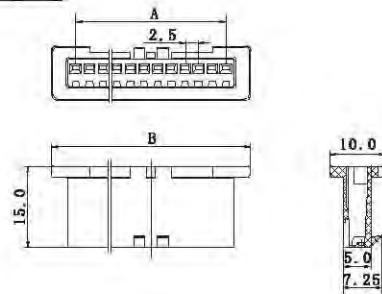
HOUSING

B250009-1-*X

B250009-2-*X

HOUSING

极数 Circuits	型号 Type	尺寸(Dimensions)mm		备注型号 P. S. Type
		A	B	
2	B250009-1-02X	2.5	8.0	XSM-02R
3	B250009-1-03X	5.0	10.5	XSM-03R
4	B250009-1-04X	7.5	13.0	XSM-04R
5	B250009-1-05X	10.0	15.5	XSM-05R
6	B250009-1-06X	12.5	18.0	XSM-06R
7	B250009-1-07X	15.0	20.5	XSM-07R
8	B250009-1-08X	17.5	23.0	XSM-08R
9	B250009-1-09X	20.0	25.5	XSM-09R
10	B250009-1-10X	22.5	28.0	XSM-10R
11	B250009-1-11X	25.0	30.5	XSM-11R
12	B250009-1-12X	27.5	33.0	XSM-12R

极数 Circuits	型号 Type	尺寸(Dimensions)mm		备注型号 P. S. Type
		A	B	
2	B250009-2-02X	2.5	11.5	XSM-02P
3	B250009-2-03X	5.0	14.0	XSM-03P
4	B250009-2-04X	7.5	16.5	XSM-04P
5	B250009-2-05X	10.0	19.0	XSM-05P
6	B250009-2-06X	12.5	21.5	XSM-06P
7	B250009-2-07X	15.0	24.0	XSM-07P
8	B250009-2-08X	17.5	26.5	XSM-08P
9	B250009-2-09X	20.0	29.0	XSM-09P
10	B250009-2-10X	22.5	31.5	XSM-10P
11	B250009-2-11X	25.0	34.0	XSM-11P
12	B250009-2-12X	27.5	36.5	XSM-12P

B250009

SM

HOUSING

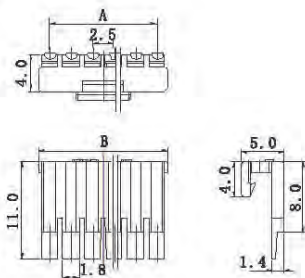
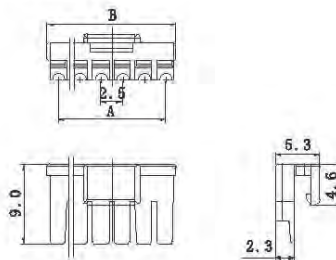
B250009-5R

B250009-5P

HOUSING

极数 Circuits	型号 Type	尺寸(Dimensions)mm		备注型号 P. S. Type
		A	B	
2	B250009-5R-02	2.5	4.9	XSM-02RST
3	B250009-5R-03	5.0	7.4	XSM-03RST
4	B250009-5R-04	7.5	9.9	XSM-04RST
5	B250009-5R-05	10.0	12.4	XSM-05RST
6	B250009-5R-06	12.5	14.9	XSM-06RST
7	B250009-5R-07	15.0	17.4	XSM-07RST
8	B250009-5R-08	17.5	19.9	XSM-08RST

极数 Circuits	型号 Type	尺寸(Dimensions)mm		备注型号 P. S. Type
		A	B	
2	B250009-5P-02	2.5	5.4	XSM-02PST
3	B250009-5P-03	5.0	7.5	XSM-03PST
4	B250009-5P-04	7.5	10.0	XSM-04PST
5	B250009-5P-05	10.0	12.5	XSM-05PST
6	B250009-5P-06	12.5	15.0	XSM-06PST
7	B250009-5P-07	15.0	17.5	XSM-07PST
8	B250009-5P-08	17.5	20.0	XSM-08PST