

B400003

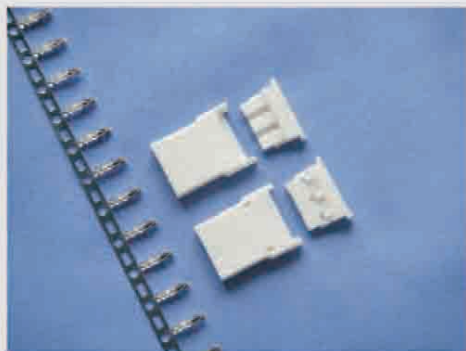

- ▶ 主要技术特性 (Main Specifications)
- ▶ 适用导线规格 (Applicable wire) : AWG26#~18#
- ▶ 适用基板厚度 (Applicable PC board thickness) : —
- ▶ 温度范围 (Temperature range) : -25°C~+85°C
- ▶ 额定电压 (Voltage rating) : 250V AC, DC
- ▶ 额定电流 (Current rating) : 2A AC, DC
- ▶ 接触电阻 (Contact resistance) : $\leq 0.02\Omega$
- ▶ 绝缘电阻 (Insulation resistance) : $\geq 1000M\Omega$
- ▶ 耐压 (Withstanding voltage) : 1000V AC/minute

材料及电镀规格 Material and Finish

型号 Type	材料 Material	材料厚度 Material Thickness	电镀规格 Finish
孔座 HOUSING	PA66 UL94V-0	—	N/A
端子 TERMINAL	铜青铜 Phosphor bronze	0.2mm	镀锡 Tin-plated

产品尺寸图 Product size chart

 单位: mm 一般公差: ± 0.20

TERMINAL

B400003-3

SBHM-001T-P0.5

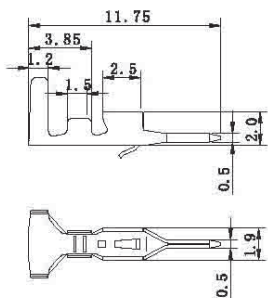

B400003-4

SBH-001T-P0.5

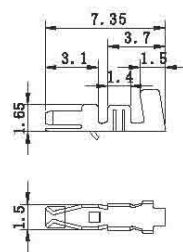

HOUSING

B400003-1

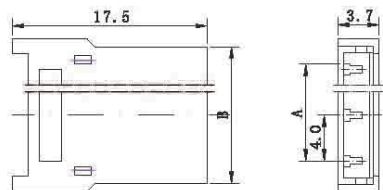

B400003-2

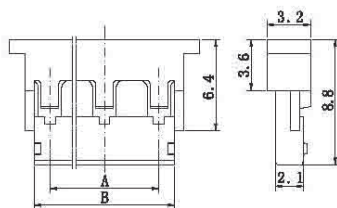

HOUSING

极数 Circuits	型号 Type	尺寸 (Dimensions) mm		备注型号 P. S. Type
		A	B	
2	B400003-1-02	4.0	7.8	BHMR-02V
3	B400003-1-03	8.0	11.8	BHMR-03V
4	B400003-1-04	12.0	15.8	BHMR-04V

HOUSING

极数 Circuits	型号 Type	尺寸 (Dimensions) mm		备注型号 P. S. Type
		A	B	
2	B400003-2-02	4.0	6.4	BHR-02VS-1
3	B400003-2-03	8.0	10.4	BHR-03VS-1
4	B400003-2-04	12.0	14.4	BHR-04VS-1